

The 1975 Brave

FILE COPY
DO NOT REMOVE



WINNEBAGO

The name that means
the most in motorhomes.



Formed to ride with the wind, the new Brave is engineered to let you cover the miles with minimum wind resistance. While retaining space advantages of the shape that made us famous. No small matter when you're climbing the mountains of Colorado.

*Sassy But Sensible
New Motorhome Value*

The 1975 Brave

Riding the range in Colorado, or hosting a fish fry at the lake, there's no place like home when home is a new Brave. One look and you know that this one is built for motorhoming fun. Today. Tomorrow. Season after season.

Because beneath that exciting new exterior beats a heart that is pure Winnebago.

And because it's a Winnebago at heart, Brave has a lot of advantages over other motorhomes in the



economy class. Now complemented by a trim new shape.

Tradition, for one thing. Brave has introduced more families to RV living than any other motorhome in its price range. They choose Brave for fully self-contained living at a modest price. From bumper to bumper, everything that's needed for sleeping, eating and relaxing. All as standard equipment.

Standard equipment that includes a responsive engine matched to the load, full-power driving aids to make the driving easy, a heavy duty chassis for a smooth, sure ride; plus a stunning interior that makes Brave the best value on the road.

And standard equipment that includes plenty of room to have a good stretch. Plenty of room to store things. On both Brave models, from 20 to 24 feet.



*A great new 20-footer
to match your ideas*

The D-20 Brave

A bath on the side provides space at the rear for an additional dinette and sleeping area in this D-20 plan. Sleep 4 persons in comfort (or 6 with optional bunk) and seal off the rear area at night for privacy from the kids.

You get a complete kitchen. A complete bath. An open airy Brave feeling for motorhoming in comfort. On an extended vacation or weekend jaunt to the lake. Comfort that extends to the driver's side too.

Just slip into the cockpit and you'll see what we mean. The steering column tilts away to let you in easy. And the plush bucket seat adjusts so you settle in as you like.

Scan the big padded dash and find all controls right at your fingertips. Look out through that big new panoramic windshield from a high, safe vantage point common to all Winnebagos.

Flick the key to your electronic ignition and the responsive V-8 engine is ready to go. Smoothly and surely. To sunshine or snow.

Livability and performance are two more reasons we're the name with the most.

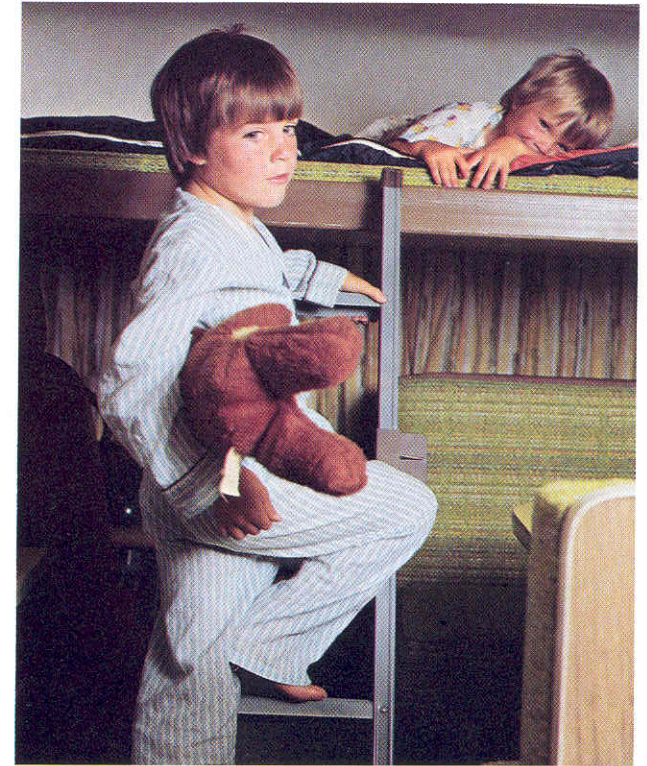
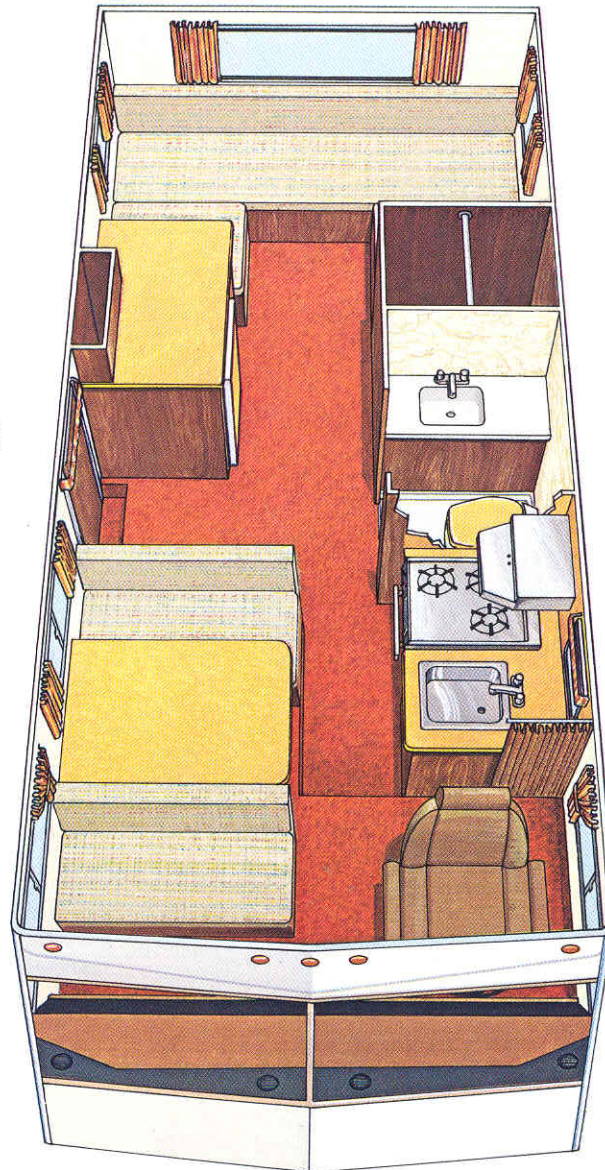

SPECIFICATIONS: Length: 20'5" / Width: 7'3" / Exterior height 9'8½" / Interior height: 6'4½" / Estimated curbside wet weight: 6,985 lbs. / Dodge RM-300 chassis / Wheel base 125" / 318 cubic-inch V-8 engine / 3-speed automatic transmission / Power steering with tilt column / Power brakes with power front disc / Electronic ignition system / Tires: 8.00 x 17.5C 8-ply front, 8.00 x 17.5C 6-ply rear duals / 60 Amp alternator / 70 Amp-hour battery / Sleeping capacity: 4 standard, 6 optional.

*Our best new Brave
is long on value*

The D-24 Brave

Our D-24 Brave shares comfort and livability features of our 20-foot Brave with an exciting difference: Four more feet to make it even more comfortable and livable.

That big combination dining and sleeping area at the rear, for example. By day, a great eating-conversation-relaxing sanctuary. By night, a 48" x 84" king-size bed.

Plus the kitchen area has even more cupboard and countertop space and a big double stainless steel sink. The wardrobe closet, too, is big in this plan.

Like our other Brave interiors, you have three beautiful color schemes to array this model to your particular taste. Choose from nugget, moss or adobe complementary woven fabrics. All enhanced by rich maple vinylface paneling and brass accent furnishings.

All drapes are on positive track slides, not flimsy, dangerous brackets. And fabric and workmanship quality is assured, since Winnebago sews every stitch. From seats and cushions to mattresses and curtains.

Beautiful interiors that won't fall apart: Another reason the name Winnebago means the most.

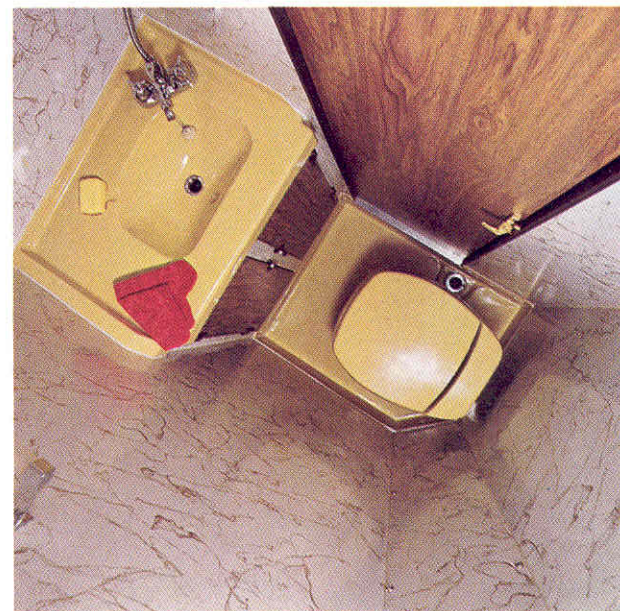
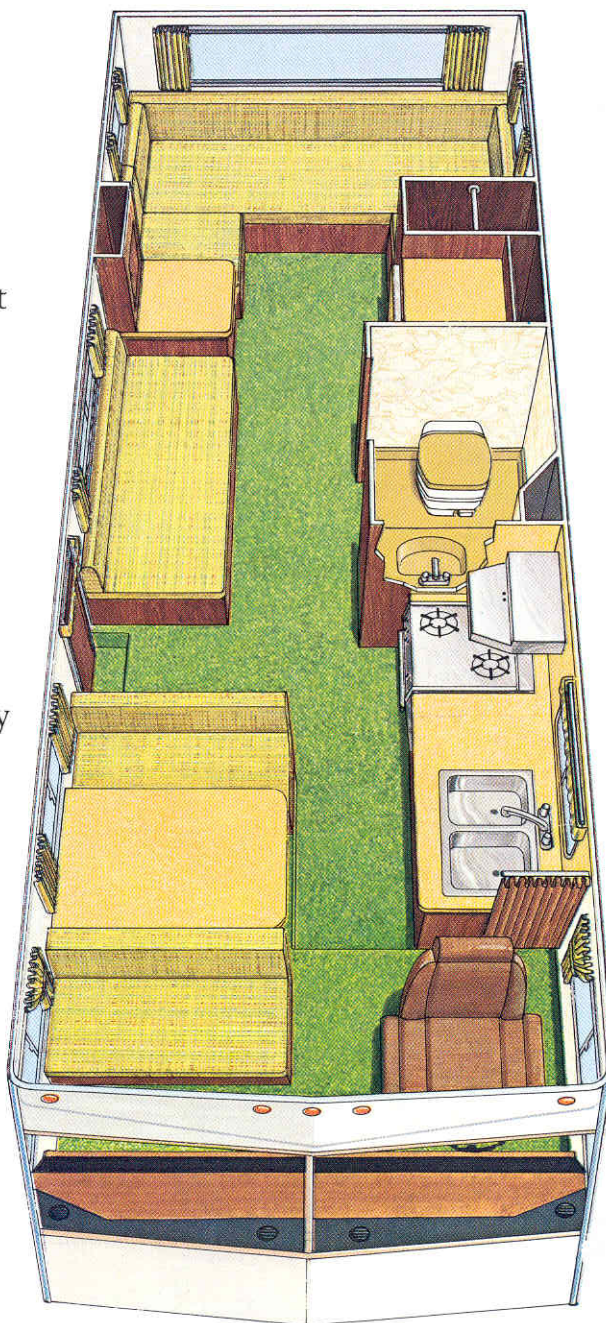

SPECIFICATIONS: Length: 23'11"/Width: 7'3"/Exterior height: 9'8½"/Interior height: 6'4½"/Estimated curbside wet weight: 7,405 lbs./Dodge RM-350 chassis/Wheel base: 159"/318 cubic-inch V-8 engine/3-speed automatic transmission/Power steering with tilt column/Power brakes with power front disc/Electronic ignition system/Tires: 8.00 x 17.5C 8-ply front, 8.00 x 17.5C 6-ply rear duals/60 Amp alternator/70 Amp-hour battery/Sleeping capacity: 6 standard, 8 optional.

Standard Equipment

You can get a Brave comfortable. Or very comfortable. Comfortable is standard and includes all the necessities of living at no extra charge. Plus a lot of other nice features for dependability and convenience. Like double sealing all windows and vents with silicone to prevent leakage. Providing easy outside access to the engine. Lining closets and cabinets. And more. More that would fill a good-sized list. A list in addition to the one we've made here for you to shop and compare.

Safety Features

- ☐ New Thermo-Steel construction
- ☐ Quick release rear escape window
- ☐ Clearance lights comply with Federal and SAE regulations
- ☐ Backup lights, parking lights, turn signals, safety flashers
- ☐ Seat belts comply with Federal regulations
- ☐ Door lock complies with National Highway Safety Bureau standard 206
- ☐ Fire extinguisher
- ☐ Tinted windows and windshield
- ☐ Twin exterior rearview mirrors
- ☐ Safety glass windshield & windows

Chassis and Automotive Features

- ☐ Heavy-duty Dodge RM-350 chassis (D-24 only)
- ☐ Heavy-duty Dodge RM-300 chassis

- ☐ New front and rear suspension system has longer and wider springs with rolled ends and non-lube rubber bushings
- ☐ 318 cubic-inch Dodge V-8 engine
- ☐ 3-speed Load-Flite automatic transmission
- ☐ Power brakes with power front disc brakes
- ☐ New rear wheel parking brake system
- ☐ Power steering with tilt column
- ☐ Electronic ignition system
- ☐ Aluminized emission control exhaust system
- ☐ Dual rear wheels with non-flat spotting recreational tires
- ☐ 60 Amp alternator
- ☐ Adjustable defroster vents with separate blower
- ☐ Fresh air automotive heater, separate blower
- ☐ Hydraulic jack
- ☐ Spare wheel
- ☐ 36-gallon gas tank
- ☐ Converter with battery charger

Driver's Compartment

- ☐ Complete instrument panel
- ☐ Removable instrument cluster
- ☐ Cigar lighter
- ☐ Ash trays
- ☐ Inside rearview mirror

- ☐ Deluxe contoured swivel bucket seat for driver, upholstered in heavy-duty vinyl

Kitchen Features

- ☐ 3-burner stove
- ☐ Stainless steel galley sink
- ☐ Easy-to-clean back splash and countertop in galley area
- ☐ 4 cubic-foot gas/electric refrigerator

Dinette Features

- ☐ Reversible fabric and vinyl dinette seats
- ☐ Dinette converts to bed

Sleeping Features

- ☐ Wardrobe
- ☐ Rear lounge and dinette convert to bed

Bathroom Features

- ☐ Shower
- ☐ Water saver phone head shower
- ☐ Shower curtain
- ☐ Marine toilet with dual holding tanks
- ☐ 6-gallon water heater operates from LP gas
- ☐ Roof vent in bath
- ☐ 30-gallon pressurized fresh water system
- ☐ Sewer hose
- ☐ Lavatory

Utility Features

- ☐ City water hook-up
- ☐ 20 lb. LP gas bottle
- ☐ Electrical 12-volt converter
- ☐ 12-volt changeover lighting system operates from battery or external 110-volt supply
- ☐ 25' 110-volt power cord

Interior Features

- ☐ Pre-finished washable paneling
- ☐ Roomy drawers for storage
- ☐ Convenient 110-volt duplex outlets on separate 110-volt wiring system
- ☐ Complete set of 12-volt bulbs
- ☐ 12-volt 110-volt converter
- ☐ Attractive color-coordinated curtains on positive track slides
- ☐ All overhead cabinets have positive door catches
- ☐ 12-volt lights over rear dinette, galley, lounges and gauchos

Exterior Features

- ☐ Radius-cornered tinted slide windows
- ☐ Glide-away step with self-cleaning mesh tread
- ☐ Pre-finished aluminum exterior
- ☐ Flush-mounted gas tank fill

Optional

It doesn't cost much more to make your comfortable Brave a very comfortable Brave. Look over the option list, and then talk to your friendly Winnebago dealer. He can help you make it as fancy as you would like.

Interior Options

- ☐ Bunk ladder
- ☐ 13,500 BTU roof air unit (D-24 only)
- ☐ 10,000 BTU roof air conditioner
- ☐ Headrest
- ☐ AM radio
- ☐ AM/FM multiplex radio
- ☐ AM/FM multiplex radio/tape deck
- ☐ Armrests
- ☐ Vinyl blackout curtain
- ☐ Wrap-around windshield curtain
- ☐ 3-burner stove with automatic oven
- ☐ 6 cubic-foot gas/electric refrigerator
- ☐ Deluxe medicine cabinet
- ☐ Holding tank and water level gauge
- ☐ Automotive air conditioning

- ☐ Windshield washers and two speed electric wipers
- ☐ Front outside access to water fill, oil fill and windshield washer fluid
- ☐ Skylight roof vent
- ☐ Large storage compartment and jack

Equipment

- ☐ Sun Visors
- ☐ Hourmeter (standard with power plant)
- ☐ Forced-air (ducted) heating system
- ☐ 23,000 BTU forced air furnace
- ☐ 28,000 BTU forced air furnace
- ☐ Deluxe wall-to-wall carpeting
- Exterior Options**
- ☐ Outside luggage compartment
- ☐ Two large chrome convex combination side mirrors
- ☐ Screen door
- ☐ 2,500-watt power plant and hourmeter
- ☐ Spare tire
- ☐ Spare tire cover and carrier
- ☐ Full wheel covers
- ☐ Limited-slip rear axle
- ☐ Trailer hitch
- ☐ Storm windows
- ☐ Two 30 lb. LP gas bottles with automatic regulator
- ☐ Gas line and wiring
- ☐ Auxiliary 70 Amp-hour battery
- ☐ Auxiliary gas tank
- ☐ 440 cubic inch engine (D-24 only)
- ☐ Second LP tank (20 lb.) and regulator

When you buy a Brave...or any Winnebago...tradition is part of the deal. A tradition of more motorhomes built than any other manufacturer. A tradition of well over a billion miles logged by Winnebago owners.

A tradition based on a solid philosophy to build the best recreational vehicle we can and to sell it for an honest price.

And that philosophy follows every Brave, every Winnebago, from the drawing board to the dealership. The dealership lot to your driveway.

Since we make almost everything that goes into a Winnebago, we know our products well. We can constantly hone and refine our models to accommodate the best use of equipment and space for your satisfaction. A good example: The great new shapes on our '75 motorhomes.

And we can constantly adjust our construction techniques to furnish you the toughest motorhome possible to make. Built for the road and for

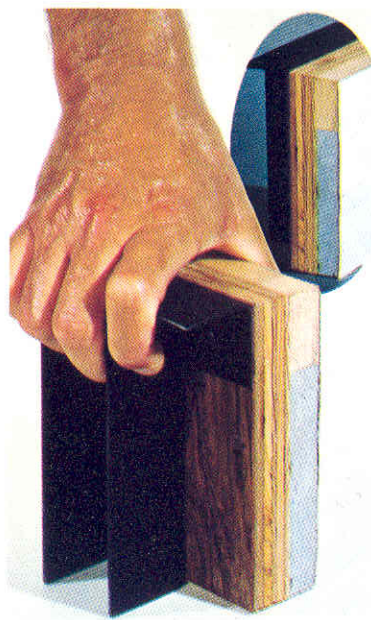

WINNEBAGO® The name that means the most in motorhomes.

strength and durability that lasts. Thermo-Steel™ construction merges the strength of steel with the superior insulating qualities of our exclusive

"Thermo-Panel®". Proven in our over a billion owner miles, Thermo-Panel® is an outer layer of rustproof aluminum and an inner wall of tough paneling bonded to either side of thick core of insulating material.

Beneath this sturdy shell is a rugged framework of heavy gauge steel, with solid angle-steel reinforcing all struc-

tural stress points throughout the unit. Winnebago has used the U. S. Department of Transportation's crash worthiness safety specifications proposed for urban transit buses as a guideline in the structural design of type A motor homes in the '75 product line.

Computer-stressed testing of frame structure is just one of the guidelines

Winnebago is conforming to meet the crash worthiness safety specifications.

Floor, walls, ceiling, and all motorhome components are anchored directly to the framework, with extra strength provided by steel members front to rear.

Up front, steel surrounds the driver's compartment. And, underneath, we add additional steel supports to heavy-duty Dodge chassis.

The result is a motorhome of solid dependable strength. In safety as in many other areas, Winnebago is a name that means the most in motorhomes.

And because it's a Winnebago, you know that even the smallest unseen detail has received its share of attention and planning.

Details like installing plastic vents in the window weep holes to prevent leakage. Using double-flared fittings on all plumbing and LP gas lines to provide tighter, longer lasting connections. Incorporating hollow core interior cabinet doors, which are lighter and resist warping. And installing a small plastic deflector on all our air-cooled power plants to prevent damage-causing sand or other ground particles from entering the air exhaust.

We didn't
get our name
by selling you
a motorhome
and then
forgetting you.



It's easy to come by service, parts and helpful advice when you choose Winnebago. Because in addition to being the largest RV manufacturer we also offer you the largest motorhome service organization in the nation. An established service network of over 300 authorized dealers from coast to coast and in Canada and Alaska is ready to serve you.

To these Winnebago dealers, motorhoming isn't a sideline. It's a full-time job and their attitudes reflect it. That's why you can count on trained experts looking after your Winnebago, whether it's tackling a problem or routine maintenance.

We're proud of these sales and service dealers. And we're proud of our name.

See the complete family of America's finest motorhomes now at your Winnebago dealer's showroom. From the most luxurious Custom to the Chieftain, Indian, Minnie Winnie, or most economical Brave, he has many different models of all RV types:

Camper coaches, trailers, 5th wheels, motorhomes, mini motorhomes and van conversions. From 14 feet to 31 feet. One visit will show you why we're the name that means the most in motorhomes.

WINNEBAGO The name that means
the most in motorhomes.

Winnebago Industries, Inc.
P.O. Box 152
Forest City, Iowa 50436

Due to continued product improvement and changes in suppliers, design and production, accuracy cannot be guaranteed in descriptive and pictorial representation of the products in this brochure. While they are believed to be current at the time of publication, equipment, colors, material specifications, and model availability are subject to change without notice. Please contact your authorized Winnebago dealer for current model specifications.

Winnebago Warranty

Winnebago Industries, Inc., warrants each new Winnebago Motor Home (excluding chassis, 110 volt power plant, and tires), Travel Trailer (excluding tires) or Camper Coach to the original purchaser as follows:

- For the life time of the unit—Winnebago Industries' exclusive "Thermo-Panel" Construction is warranted against defects in lamination for the lifetime of the Winnebago Motor Home Body, Travel Trailer, or Camper Coach.
- For the period of one year from the date of purchase—air compressor, air conditioner (auto), air conditioner (roof), antenna, axles (TT), auxiliary battery (MH), battery (TT), brake assembly (TT), converter, speed control, demand pump, furnace, hitch (TT), LP gas bottle(s), power range hood, pre-finished panelling, range, radio, refrigerator, sink, stereo, vacuum cleaner, gauges, water conditioner, toilet, and water heater.
- For the period of 90 days from the date of purchase—carpet, cushion foam, compartment doors, drainage hose, driver and passenger seats, electrical systems, cushion fabric, fire extinguisher, plastic refrigerator interior door, faucets, light fixtures, plumbing system, switches, shower door, shower head, vinyl, jack (MH), sealants, LP gas valves, and windows.

Any part of the Winnebago Motor Home, Travel Trailer or Camper Coach subject to this warranty which is found to be defective in material or workmanship, will be repaired or replaced, at Winnebago Industries' option, by the selling dealer without charge for parts or labor. If the selling dealer has ceased to do business as an authorized Winnebago dealer or the owner is traveling or has moved to a different locality and cannot return to the selling dealer, the owner may obtain warranty repairs or replacement at any authorized Winnebago Dealership.

Winnebago Industries, Inc., cannot, however, and does not accept any responsibility in connection with any of its Motor Homes, Travel Trailers, or Camper Coaches when they have been altered outside of its own factory. If the purchaser shall use or allow to be used in the Motor Home, Travel Trailer or Camper Coach, equipment and/or parts not made or supplied by Winnebago Industries, Inc., then this warranty shall become void, if failure is a result of improper installation or adaption.

Winnebago Industries, Inc., does not undertake responsibility to any purchaser of its products for any undertaking, representation or warranty made by dealers selling its products beyond those herein expressed.

This express warranty is the only warranty applicable to the Winnebago Motor Home, Travel Trailer, or Camper Coach and is expressly in lieu of any warranties otherwise implied by law (including but not limited to implied warranties of merchantability or fitness for any particular purpose). The remedies available under this express warranty shall be the only remedies available to the purchaser-user with respect to defects in material or workmanship.

Without regard to the alleged defect, Winnebago Industries, Inc., under any circumstances, does not assume any responsibility for loss of time, inconvenience or other consequential damage including, but not limited to, expense for gasoline, telephone, travel, lodging, loss or damage to personal property or loss of revenue.

Winnebago Industries, Inc., reserves the right to make changes in design and changes or improvements upon its products without imposing any obligation upon itself to install the same upon its products theretofore manufactured.

It is the obligation of each Winnebago dealer to provide full service for owners of Winnebago Motor Homes, including Winnebago installed and/or approved components as to all aspects of said products. If the dealer is unable to provide said service at his place of business, the dealer will, at his own expense, secure said service for you from other firms authorized to service the various components in your Winnebago Motor Home.